



ADHARIA

LUXURY FLOATING SUITES & APARTMENTS



OUTLINE

CONCEPT
SUSTAINABILITY
MODULARITY
DOMOTIC SYSTEM
PERSONALIZATION
BOUNDLESS MOBILITY
MADE IN ITALY
CERTIFICATIONS
PATENTS



**INNOVATION
CELEBRATING WATER.**

**GREEN HEART.
SUSTAINABLE SOUL.**



ADHARIA
LUXURY FLOATING SUITES & APARTMENTS



**ELEGANCE, STYLE
AND UNIQUENESS.
BEYOND
CONVENTIONAL
LUXURY**



**THE FLOATING OASIS
BRINGING MAN
CLOSER TO NATURE**



ADHARIA
LUXURY FLOATING SUITES & APARTMENTS

THE NEW FRONTIER
OF **HOSPITALITY** AND
LUXURY RESIDENCES.



ADHARIA
LUXURY FLOATING SUITES & APARTMENTS

URBAN RESORT



ADHARIA
LUXURY FLOATING SUITES & APARTMENTS



URBAN RESORT



ADHARIA
LUXURY FLOATING SUITES & APARTMENTS



LAKE RESORT



ADHARIA
LUXURY FLOATING SUITES & APARTMENTS



MARINE RESORT



ADHARIA
LUXURY FLOATING SUITES & APARTMENTS



SUSTAINABILITY

The sustainable architecture of the floating suite encourages interaction with the surrounding Nature, while safeguarding the Environment and contributing to Energy efficiency



ADHARIA
LUXURY FLOATING SUITES & APARTMENTS

THE BEST GREEN FEATURES

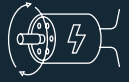

ELECTRIC ENGINES

For zero-impact mobility.



GREEN ROOFS

That ensure temperature control inside the suite.



PHOTOVOLTAIC SYSTEM WITH STORAGE.

Provides an alternative to greenery on the roof.



RAINWATER RECOVERY AND RECYCLING SYSTEM

In order to water the planters on the sundeck.

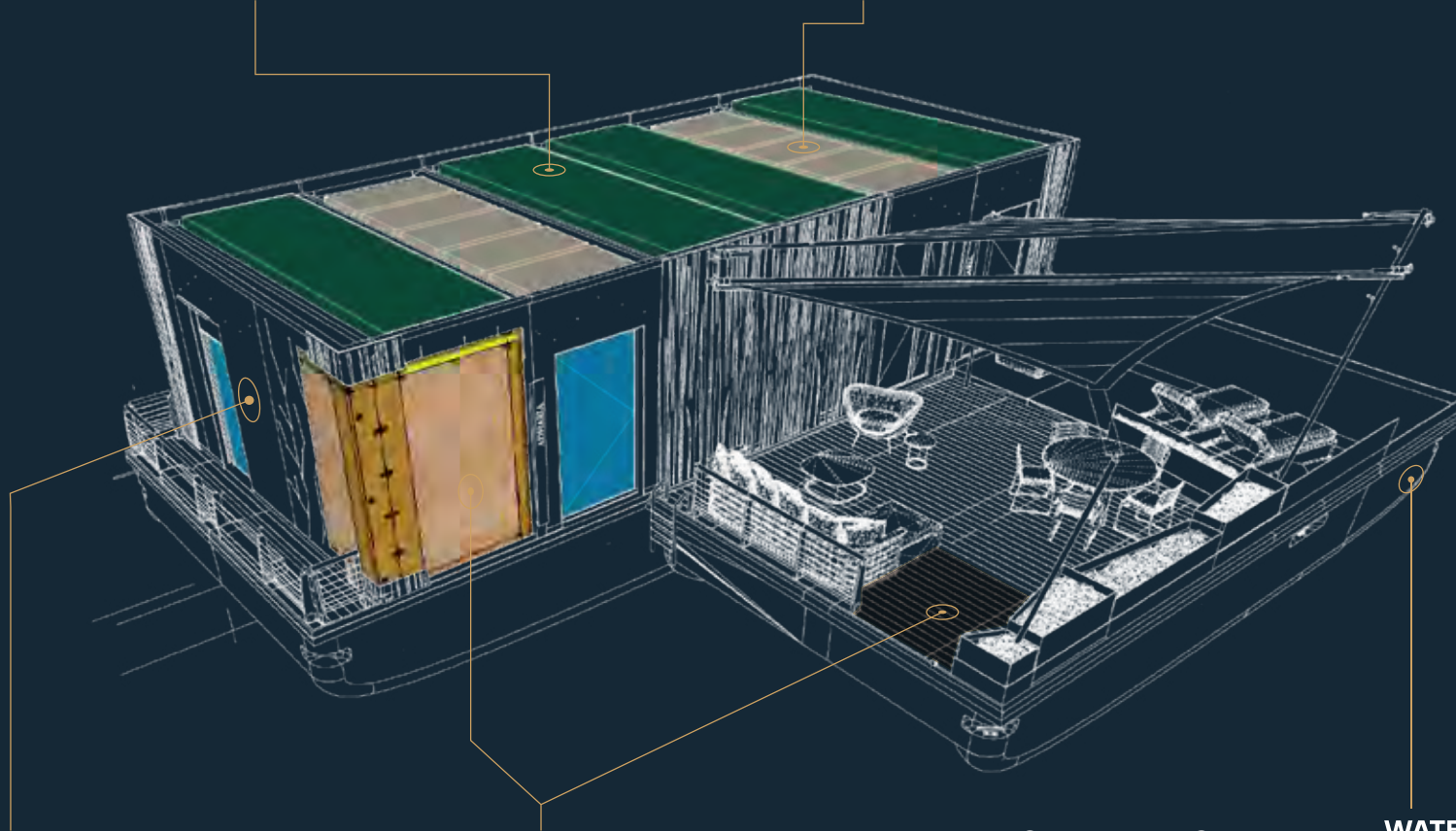

WINDOWS EQUIPPED WITH SUN-STOP CRYSTALS



ECO-FRIENDLY MATERIALS FOR THE MARINE ENVIRONMENT

Non-polluting and easy to be recycled (cork, bamboo and plasterboards)



PHYTO-DEPURATION SYSTEM

For the treatment of black and grey waters



WATER MONITORING SYSTEM

In order to check the correct functioning of the phyto-depuration system

MODULARITY

The modular structure shows the way through which technology can easily adapt to the surrounding environment.



ADHARIA
LUXURY FLOATING SUITES & APARTMENTS

MODULAR BALANCE

CUSTOMIZING DIMENSIONS



ADHARIA
LUXURY FLOATING SUITES & APARTMENTS

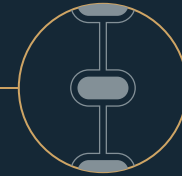
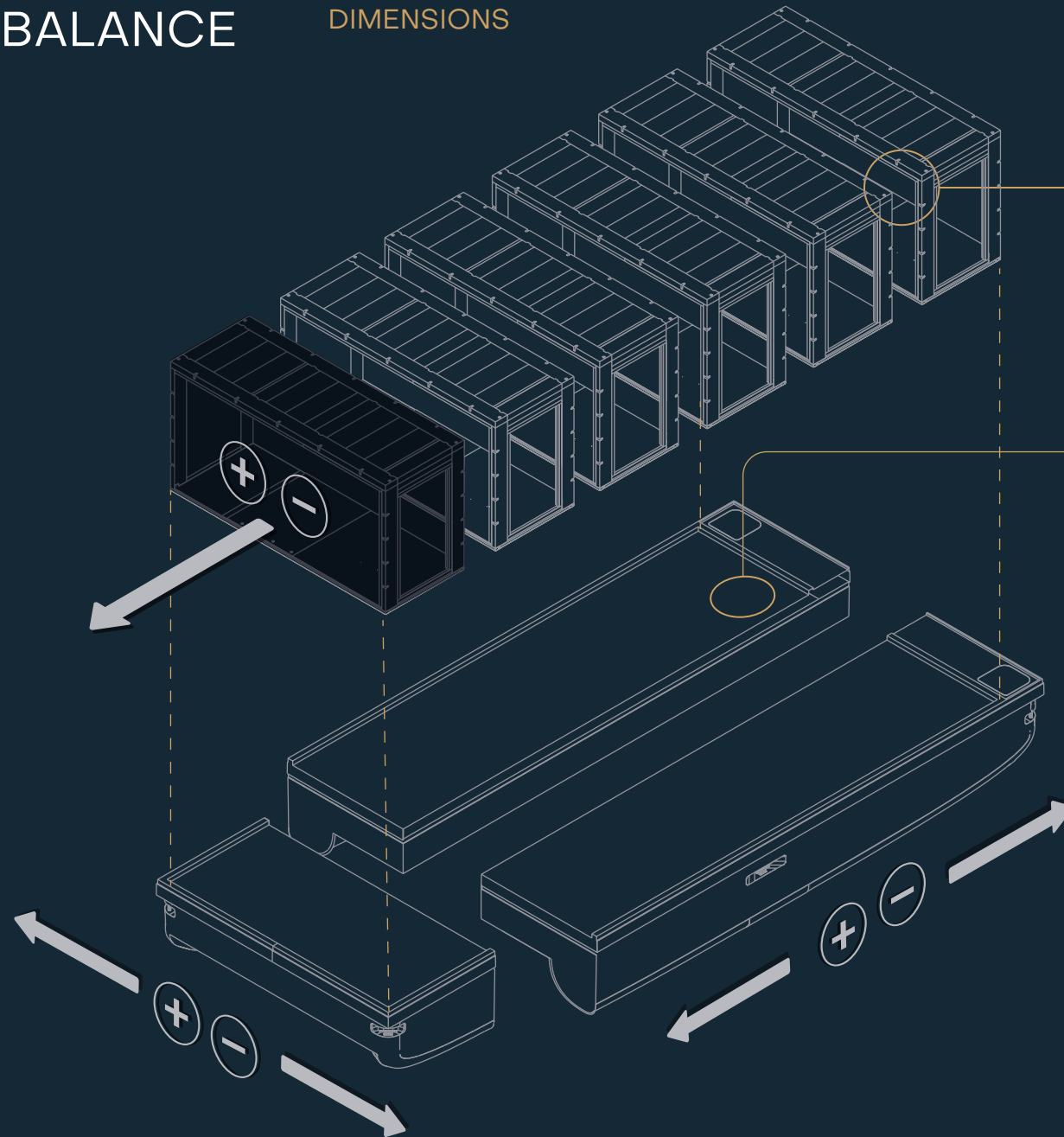

PLUG-IN MODULES

Through this system, the modules are already pre-assembled upon delivery.



PLUG-IN SYSTEMS

Through this system, all installations provided are pre-wired and functional from an operating stand-point.

Adharia's modular construction enables the industrialization of production processes and the off-site construction of floating suites. This optimizes resources, protects the environment, reduces costs, time and CO₂ emissions.

MODULAR BALANCE

LAYOUT
CUSTOMIZATION



ADHARIA
LUXURY FLOATING SUITES & APARTMENTS

HALL

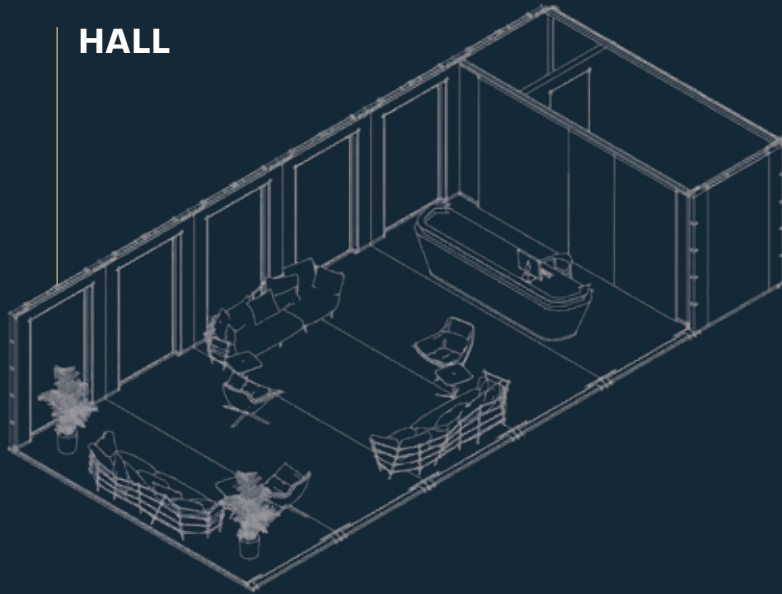

APARTMENT

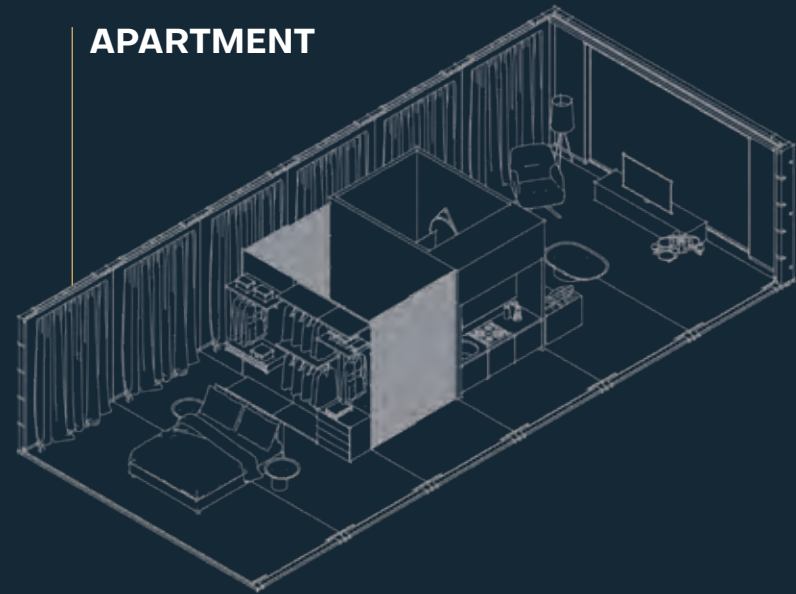

RESTAURANT

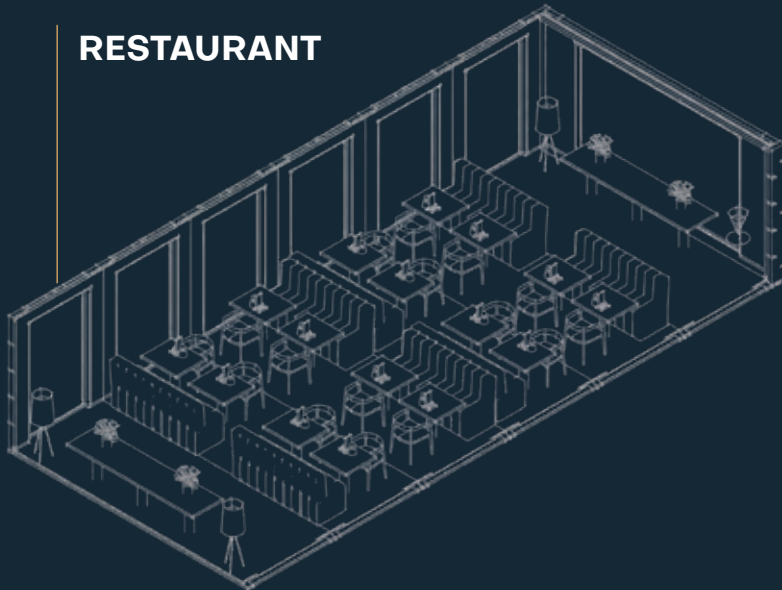

FITNESS AREA



MODULAR BALANCE

MOCKUP
AND LAYOUT



ADHARIA
LUXURY FLOATING SUITES & APARTMENTS

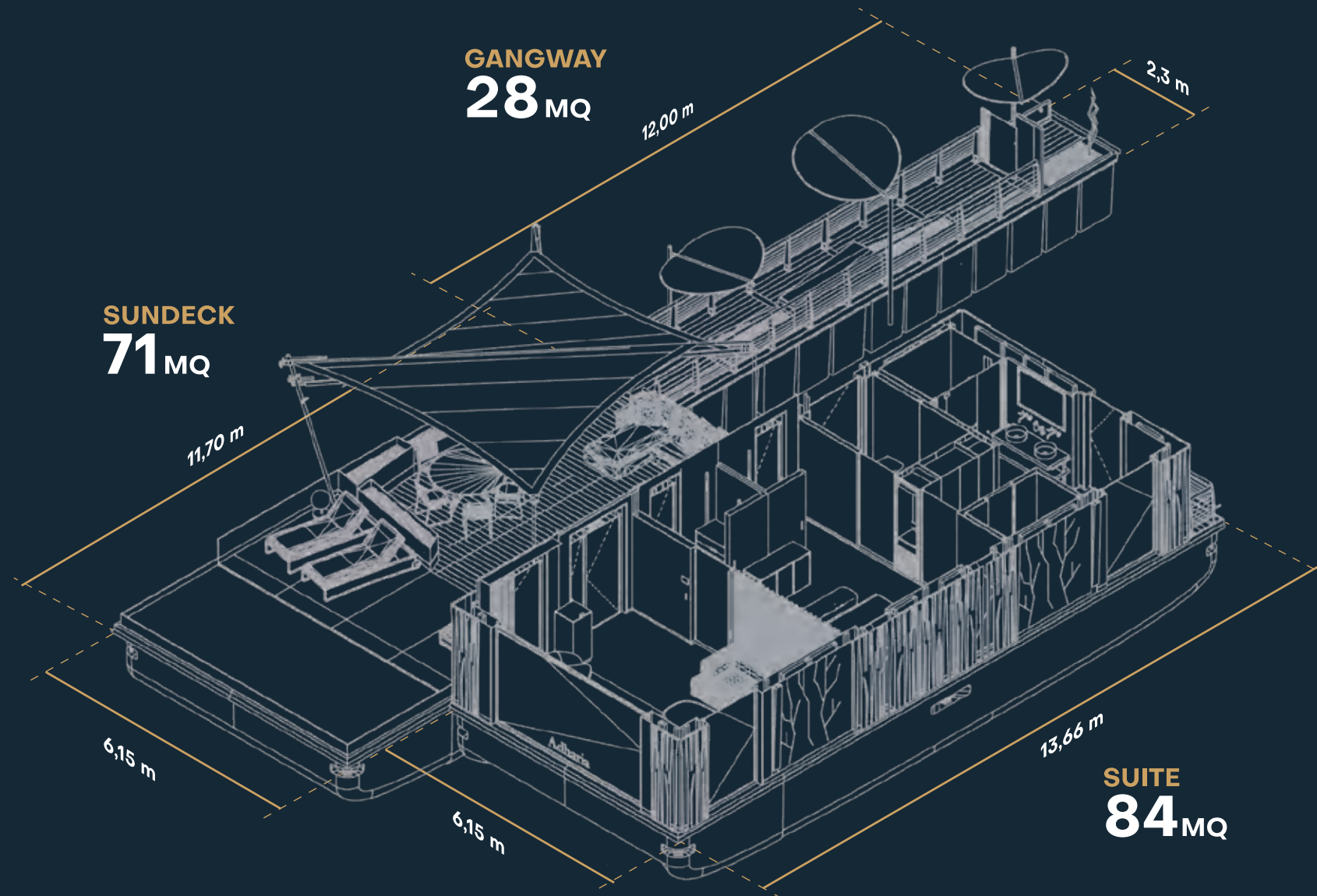

DOMOTIC SYSTEM

The implemented technology system allows the remote monitoring as well as the assistance, and the optimization of energy efficiency.



ADHARIA
LUXURY FLOATING SUITES & APARTMENTS

OUTSTANDING HOME AUTOMATION



ADHARIA
LUXURY FLOATING SUITES & APARTMENTS



REMOTE MAINTENANCE
MANAGEMENT



VOIP COMMUNICATION SYSTEM
EQUIPPED WITH AN INTEGRATED
CAMERA



HUMAN-CENTRIC LIGHTING
CHARACTERIZES THE SPREAD OF
LIGHT WITHIN THE FLOATING SUITE



MONITORING OF ENERGY
CONSUMPTION AND PRODUCTION



MATERIC SPEAKERS EQUIPPED WITH
AN INTEGRATED LIGHT SYSTEM

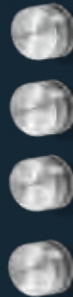

QD-OLED SMART TV WITH
REMOTE IP AND DIAGNOSTIC
FUNCTIONS



REMOTE CONTROL
FROM SMARTPHONE



INTERNAL TEMPERATURE
REGULATION



TIMER/ALARM CLOCK
PROGRAMMING SYSTEM



WEATHER
MONITORING SYSTEM

PERSONALIZATION

An innovative way for guests to enjoy a temporary stay in an environment wherein each feature can be designed and customized according to his concept and design requirements.



ADHARIA
LUXURY FLOATING SUITES & APARTMENTS

COUNTLESS NUMBERS OF BESPOKE FEATURES

The floating suite is designed in order to satisfy all needs and requirements as far as:

- Furniture selection
- Interior and exterior finishes
- Customization of building materials



ADHARIA
LUXURY FLOATING SUITES & APARTMENTS



BOUNDLESS MOBILITY



ADHARIA
LUXURY FLOATING SUITES & APARTMENTS

BOUNDLESS MOBILITY



ADHARIA
LUXURY FLOATING SUITES & APARTMENTS

The hull modules and components of the floating suite can be **transported and delivered within containers**. Their construction can be completed once they reach the destination site. Furthermore, as a subsequent step, the plug-in modules and systems ensure a rapid and easy on-site assembling method.

The modules require a limited space within a container, thus ensuring a relevant reduction of CO₂ emissions during transportation.



ON-LAND
TRANSPORTATION



SHIPPING
TRANSPORTATION



SHIPPING
BY AIR

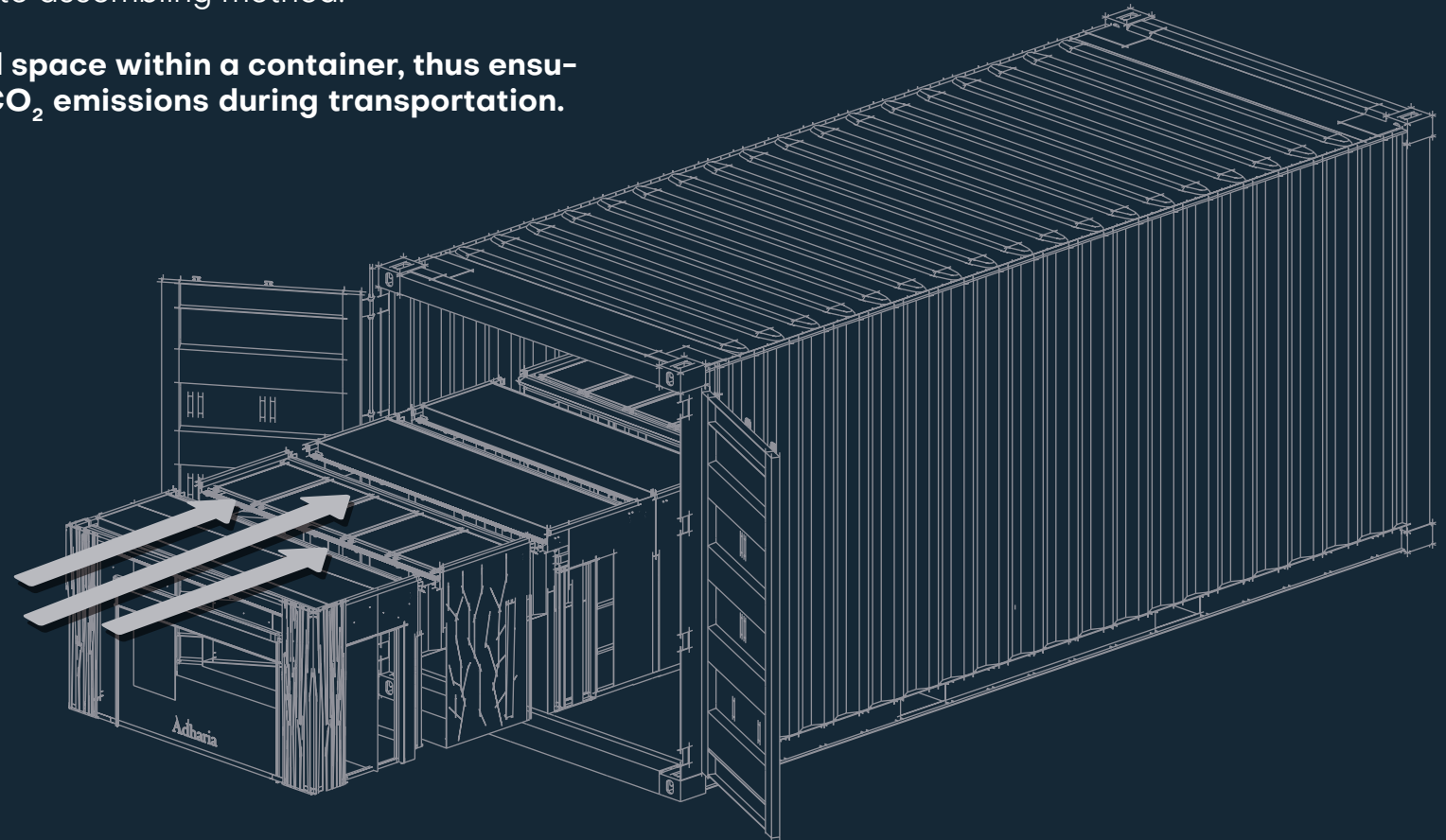

MADE IN ITALY

The Floating Suite & Apartments aim to become an icon of the Made in Italy as far as the luxury hospitality sector is concerned. Technology, sustainability and style features as well as uniqueness are ensured by the selected Italian partners who are the market leaders in their production sector and who share with us the same values and goals.



ADHARIA
LUXURY FLOATING SUITES & APARTMENTS

MADE IN ITALY



ADHARIA
LUXURY FLOATING SUITES & APARTMENTS



CERTIFICATIONS



ADHARIA
LUXURY FLOATING SUITES & APARTMENTS

CERTIFICATIONS



ADHARIA
LUXURY FLOATING SUITES & APARTMENTS

The structure of the floating suite is made from **FSC** and **PEFC** certified materials, larch wood in particular, originating from certified forests proving to have a minimal impact on the Environment



The floating suite is certified as **NZEB** (Nearly Zero Energy Building) thanks to the use of innovative construction solutions and systems that guarantees energy consumption close to zero



The engineering department of the University of Sannio has certified that the floating suite qualifies as an nearly zero-energy structure with reduced environmental impact, suitable for accreditation to the most stringent standards related to the global sustainability of artifacts.



According to the standards issued by **Bureau Veritas** that are recognized on a worldwide basis, the design and the construction features gained the **Approval in Principal (AIP)** as a Class Certification



PATENTS



ADHARIA
LUXURY FLOATING SUITES & APARTMENTS



Patent for Modular Housing Structure:

The modular housing structure comprises a plurality of modular elements and related connecting means for their mutual connection. The goal of the patent is to achieve a modular structure that allows flexible management of interior spaces and a reduction in the time and costs associated with assembly.

Patent for Plug-in Module System:

The magnetic system for plug-in modules facilitates assembly, movement, and modification of the structure's configuration according to the user's needs.

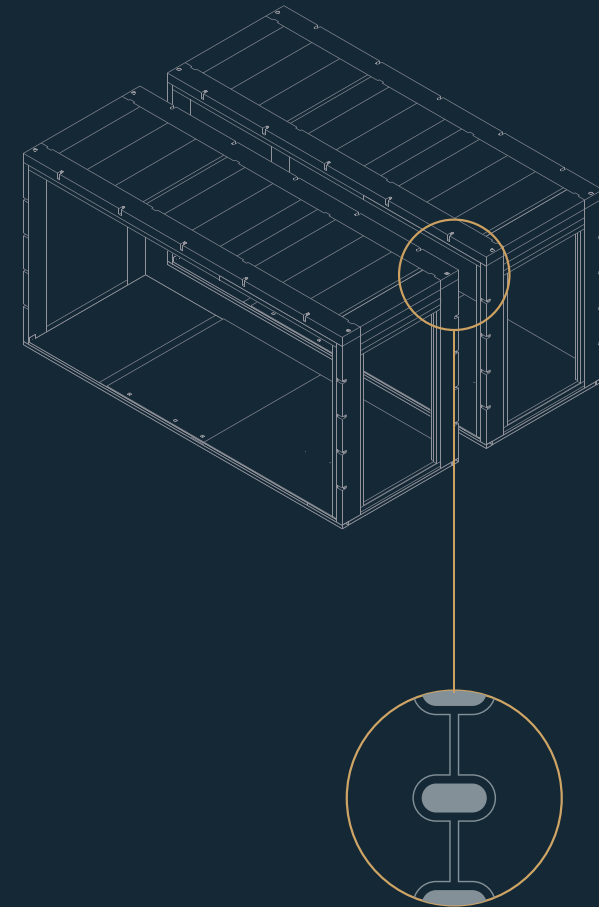

GALLERY

MOCKUP



ADHARIA
LUXURY FLOATING SUITES & APARTMENTS



ADHARIA
LUXURY FLOATING SUITES & APARTMENTS



ADHARIA
LUXURY FLOATING SUITES & APARTMENTS



ADHARIA
LUXURY FLOATING SUITES & APARTMENTS



ADHARIA
LUXURY FLOATING SUITES & APARTMENTS



ADHARIA
LUXURY FLOATING SUITES & APARTMENTS



ADHARIA
LUXURY FLOATING SUITES & APARTMENTS



ADHARIA
LUXURY FLOATING SUITES & APARTMENTS



ADHARIA
LUXURY FLOATING SUITES & APARTMENTS



ADHARIA
LUXURY FLOATING SUITES & APARTMENTS



ADHARIA

ADHARIA



ADHARIA
LUXURY FLOATING SUITES & APARTMENTS



ADHARIA
LUXURY FLOATING SUITES & APARTMENTS



01



ADHARIA
LUXURY FLOATING SUITES & APARTMENTS



ADHARIA
LUXURY FLOATING SUITES & APARTMENTS



ADHARIA
LUXURY FLOATING SUITES & APARTMENTS



ADHARIA
LUXURY FLOATING SUITES & APARTMENTS

adharia.com

